



Installation manual

ELECTROMAGNETIC LOCKS

AND MOUNTING BRACKETS

 **KaDe**

VERSION 3.0 07-07-2020



AAT SYSTEMY BEZPIECZEŃSTWA Sp. z o.o.

431 Pulawska St, 02-801 Warsaw, phone: +48 22 546 05 46, fax: +48 22 546 05 01
www.aat.pl

CONTENTS

DIRECTIVES	3
SAFEGUARDS AND WARNINGS	4
1. INTRODUCTION	5
2. COMMERTIAL SIGN EXPLANATION	5
3. ELECTROMAGNETIC LOCKS' TECHNICAL PARAMETERS	5
4. ELECTROMAGNETIC LOCKS' ELECTRICAL CONNECTIONS	6
4.1. KDA-LOCK180Z-II	6
4.2. KDA-LOCK280DZC-II/350DZC/500DZC-II	6
5. KADE LOCKS AND COMPATIBLE BRACKETS LIST	6
6. ELECTROMAGNETIC LOCKS MOUNTING WAYS	7

THE PRODUCT MEETS THE REQUIREMENTS CONTAINED IN THE FOLLOWING DIRECTIVES:



Directive 2014/30/EU of the European Parliament and of the Council of 26 February 2014 on the harmonisation of the laws of the Member States relating to electromagnetic compatibility (recast) Text with EEA relevance.



Directive 2012/19/EU of the European Parliament and of the Council of 4 July 2012 on waste electrical and electronic equipment (WEEE) Text with EEA relevance



Directive 2011/65/EU of the European Parliament and of the Council of 8 June 2011 on the restriction of the use of certain hazardous substances in electrical and electronic equipment Text with EEA relevance

Information

The device, as a part of professional intercom system used for surveillance and control, is not designed for self-installation in households by individuals without technical knowledge

WARNING!

PRIOR TO UNDERTAKING ANY ACTION THAT IS NOT DESCRIBED FOR THE GIVEN PRODUCT IN USER'S MANUAL AND OTHER DOCUMENTS DELIVERED WITH THE PRODUCT, OR IF IT DOES NOT ARISE FROM THE USUAL APPLICATION OF THE PRODUCT, MANUFACTURER MUST BE CONTACTED UNDER THE RIGOR OF EXCLUDING THE MANUFACTURER'S RESPONSIBILITY FOR THE RESULTS OF SUCH AN ACTION.

WARNING!

THE KNOWLEDGE OF THIS MANUAL IS AN INDESPENSIBLE CONDITION OF A PROPER DEVICE OPERATION. YOU ARE KINDLY REQUESTED TO FAMILIRIZE YOURSELF WITH THE MANUAL PRIOR TO INSTALLATION AND FURTHER DEVICE OPERATION.

WARNING!

USER IS NOT ALLOWED TO DISASSEMBLE THE CASING AS THERE ARE NO USER -SERVICEABLE PARTS INSIDE THIS UNIT. ONLY AUTHORIZED SERVICE PERSONNEL MAY OPEN THE UNIT INSTALLATION AND SERVICING SHOULD ONLY BE DONE BY QUALIFIED SERVICE PERSONNEL AND SHOULD CONFORM TO ALL LOCAL REGULATIONS

IMPORTANT SAFEGUARDS AND WARNINGS:

1. Prior to undertaking any action please consult the following manual and read all the safety and operating instructions before starting the device.
2. Please keep this manual for the lifespan of the device in case referring to the contents of this manual is necessary;
3. All the safety precautions referred to in this manual should be strictly followed, as they have a direct influence on user's safety and durability and reliability of the device;
4. All actions conducted by the servicemen and users must be accomplished in accordance with the user's manual;
5. The device should be disconnected from power sources during maintenance procedures;
6. Usage of additional devices and components neither provided nor recommended by the producer is forbidden;
7. Mounting the device on unstable surface or using not recommended mounts is forbidden.
8. Improperly mounted device may cause a fatal accident or may be seriously damaged itself. Device must be mounted by qualified personnel with proper authorization, in accordance with this user's manual;
9. Device should be supplied only from a power sources whose parameters are in accordance with those specified by the producer in the device's technical datasheet. Therefore, it is forbidden to supply the device from a power sources with unknown parameters, unstable or not meeting producer's requirements;
10. Signal and power cables should be placed in a way excluding the possibility of damaging them by accident. Special attention must be paid to cables getting from the device and connecting the power supply;
11. Electric installation supplying the device should be designed to meet the specifications given by the producer in such a way that overloading is impossible;
12. User cannot repair or upgrade the equipment himself. All maintenance actions and repairs should be conducted only by qualified service personnel;
13. Unplug the device from the power source immediately and contact the proper maintenance department when the following occurs:
 - Damages to the power cord or to the plug itself;
 - Liquids getting inside the device or exposure to strong mechanical shock;
 - Device behaves in a way not described in the manual and all adjustments approved by the manufacturer and possible to apply by user himself, seem not to have any effect;
 - Device is damaged;
 - Atypical behaviour of the device components may be seen (heard).
14. In necessity of repairs attention to using only original replacement parts (with their parameters in accordance with those specified by the producer) should be paid. Non-licensed service and non-genuine replacement parts may cause fire or electrocution;
15. After maintenance activities tests should be run to ensure proper operation of all the functional components of the device.

1. INTRODUCTION

Electromagnetic locks are one of the device types allowing door locking in physical access control system. KaDe trademark offers wide range of locks with different parameters. Some models offer additional functionalities (e.g. built-in door state sensor). It allows to choose an equipment suitable for the customer.

2. COMMERCIAL SIGN EXPLANATION

Commercial signs of KaDe locks contain information about technical parameters and additional properties. Signs are explained below.

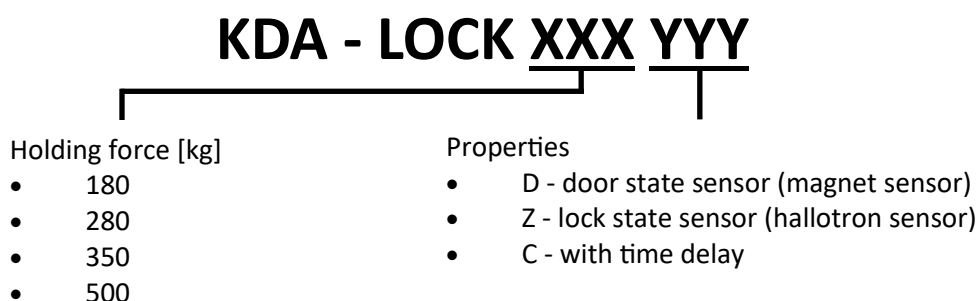

3. ELECTROMAGNETIC LOCKS' TECHNICAL PARAMETERS

Model	Current consumption [mA] 12 VDC power supply	Current consumption [mA] 24 VDC power supply	Dimensions [mm] L x H x W
KDA-LOCK180Z-II	280	240	170 x 39 x 24
KDA-LOCK280DZC-II	480	240	250 x 47 x 29
KDA-LOCK350DZC	480	240	288 x 55 x 29
KDA-LOCK500DZC-II	660	330	265 x 71 x 38

4. ELECTROMAGNETIC LOCKS' ELECTRICAL CONNECTIONS

Electrical connection schemes of KaDe electromagnetic locks are shown in the pictures below.

4.1. KDA-LOCK180Z-II

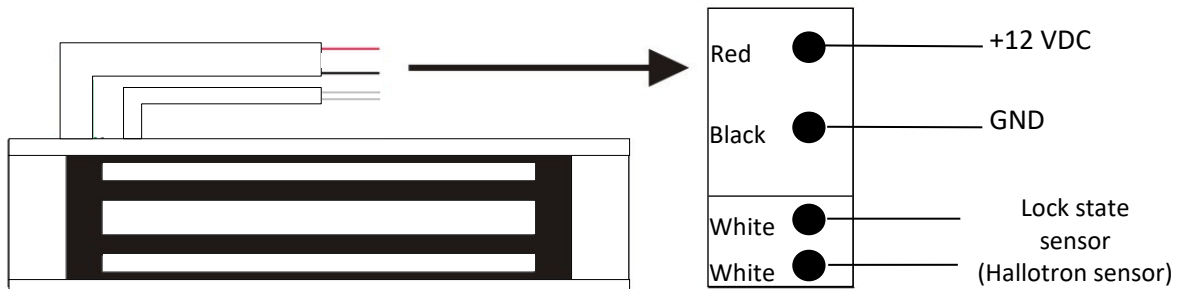

4.2. KDA-LOCK280DZC-II/350DZC/500DZC-II

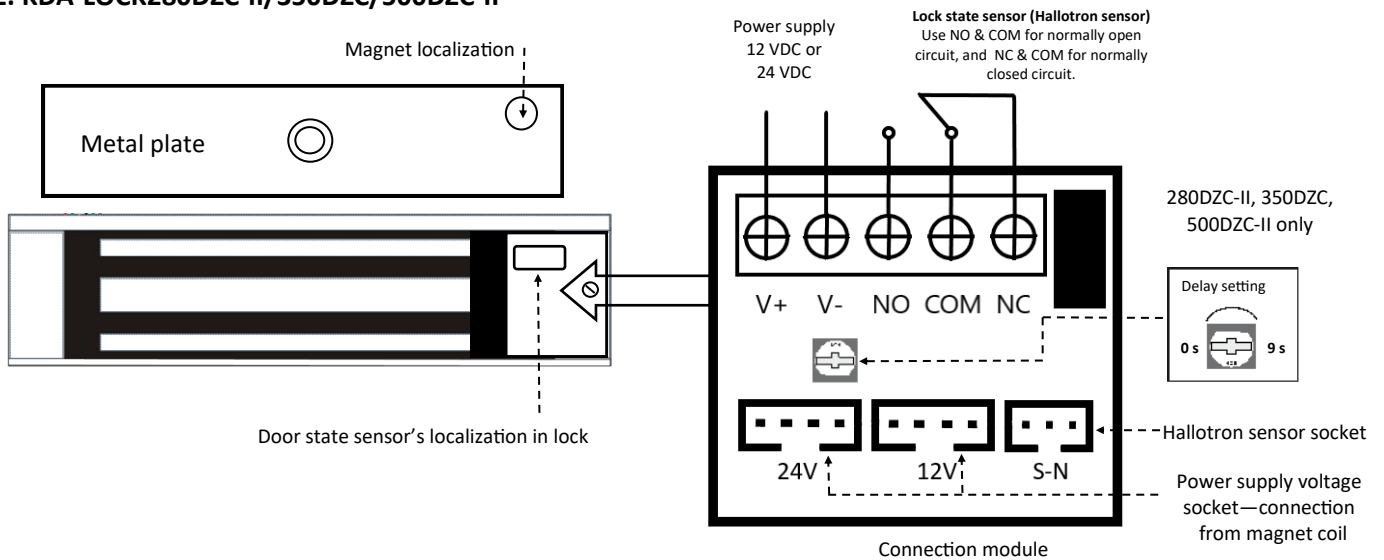

5. KADE LOCKS AND COMPATIBLE BRACKETS LIST

The table below shows available electromagnetic locks and compatible mounting brackets in the offer.

Electromagnetic lock	„BZLC” type bracket	„L” type bracket	„ZL” type bracket
KDA-LOCK180Z-II	-	KDA-BL180-II	KDA-BZL180-II
KDA-LOCK280DZC-II	KDA-BZLC280-II	KDA-BL280-II	KDA-BZL280-II
KDA-LOCK350DZC	-	KDA-BL350	KDA-BZL350
KDA-LOCK500DZC-II	-	KDA-BL500-II	KDA-BZL-500-II

6. ELECTROMAGNETIC LOCKS MOUNTING OPTIONS

Depending on door construction, doorframe width and door wing material there are different electromagnetic locks' mounting ways. In KaDe offer there are different types of brackets (L, ZL, ZLC), which allow to install the lock on various doors.

STANDARD LOCKS MOUNTING

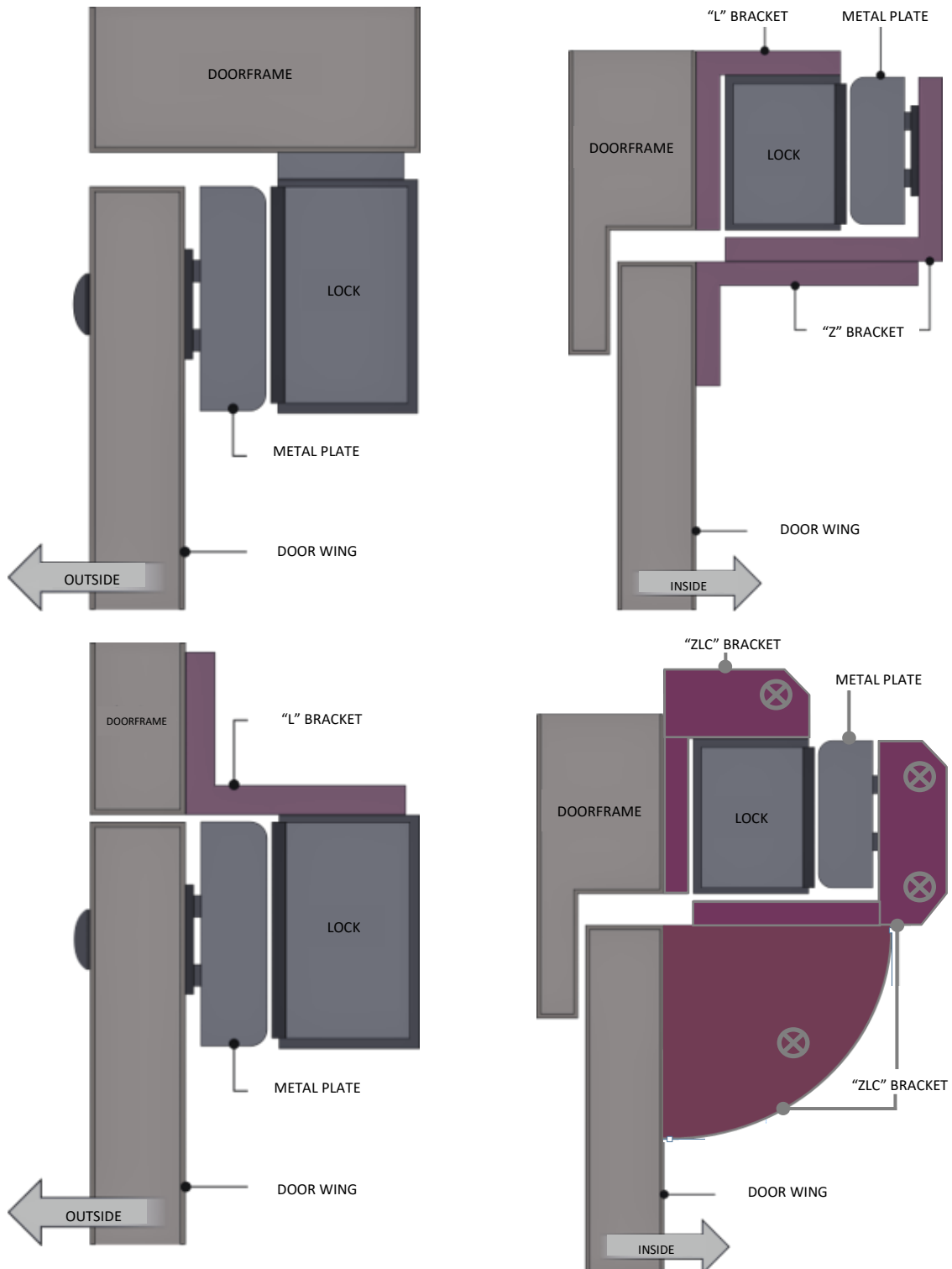

 **KaDe**



AAT SYSTEMY BEZPIECZEŃSTWA Sp. z o.o.

431 Pulawska St, 02-801 Warsaw, phone: +48 22 546 05 46, fax: +48 22 546 05 01

www.aat.pl